



Izerwaren
Order
numbers

- Stainless steel hinges
- Sea water resistant
- Satin stainless steel

42.503
42.504

Left Hand
Right Hand
Lift off hinge rounded corners
100 x 85 x 3 mm
barrel 16 mm diameter, pin 10 mm
304 stainless steel
specify left or right

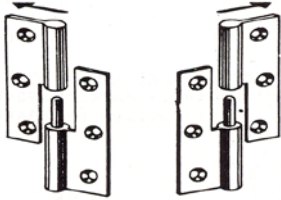

DIN left DIN right

**EXTERIOR GRADE 304 STAINLESS STEEL
LIFT OFF HINGES**

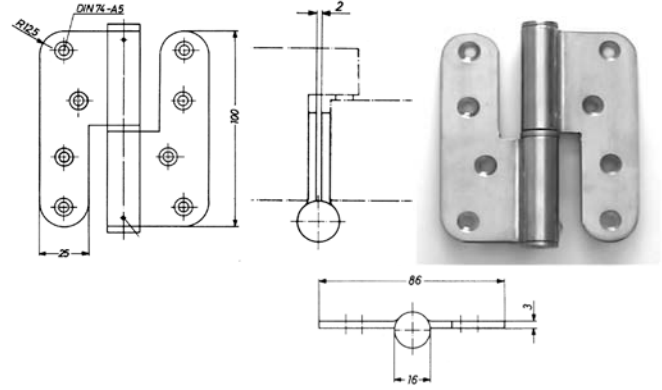

Lift off hinge 100 high x 85 mm wide: #42.503 and #42.504
Lift off hinge 95 high x 90 mm wide 4 mm thick #42.505 and 42.506

Half Wide Hinges

Non removable pin
304 stainless steel
Interior grade

	high x wide x thick	inch sizes
42.523	40 x 32 x 0.9 mm	~ 1 7/16 x 1 1/4
42.524	50 x 39 x 1.0 mm	~ 2 x 1 1/2
42.525	60 x 46 x 1.2 mm	~ 2 3/8 x 1 13/16
42.526	80 x 58 x 1.5 mm	~ 3 1/8 x 2 1/4
42.527	100 x 72 x 1.5 mm	~ 4 x 2 13/16

**INTERIOR GRADE 304 STAINLESS STEEL
CABIN AND CABINET HINGES**

Half Wide Hinges - Non removable pin

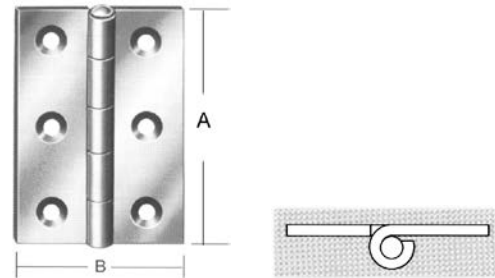

half wide hinge #42.52xx

**INTERIOR GRADE 304 STAINLESS STEEL
CABINET HINGES**

Narrow Hinges - Non removable pin

Narrow hinges for cabinet doors

Non removable pin
304 stainless steel
Interior grade

	high x wide x thick	inch sizes
42.513	30 x 22 x 0.8 mm	~ 1 3/16 x 7/8
42.514	40 x 26 x 0.9 mm	~ 1 7/16 x 1
42.515	50 x 31 x 1.0 mm	~ 2 x 1 1/4
42.516	60 x 34 x 1.2 mm	~ 2 3/8 x 1 3/8
42.518	80 x 41 x 1.5 mm	~ 3 1/8 x 1 5/8
42.519	100 x 52 x 1.5 mm	~ 4 x 2

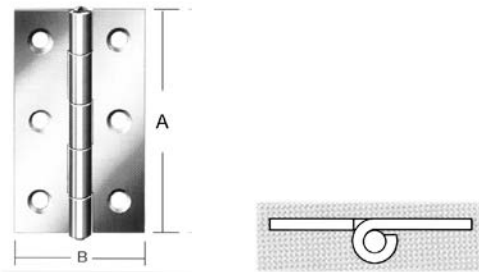

narrow hinge #42.51xx

Lift off Cabinet Hinge

304 stainless steel
Interior grade

	high x wide x thick	inch sizes
42.20050	50 x 40 x 1.5 mm Left	2 x 1 9/16
42.20051	50 x 40 x 1.5 mm Right	2 x 1 9/16

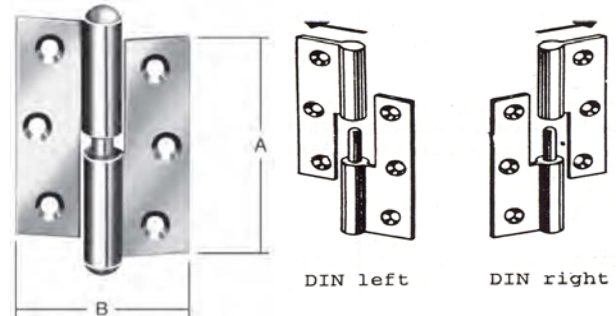

#42.20050 Left Hand lift of hinge
#42.20050 Left Hand lift of hinge